

Die Grinders

For precise and delicate finishing, such as deburring and removing points.

■ Lever Type / Safety Lever Type



RG-16AK-06 (6mm collet)
Aluminium housing



Lever Type **RG-25-06** (6mm collet)
RG-25-20 (1/4" collet)
Safety Lever Type **RG-25LW-06** (6mm collet)
RG-25LW-20 (1/4" collet)
Aluminium housing
*3mm & 1/8" collets also available.

■ Grip Type



RG-38CA-06 (6mm collet)
RG-38CA-20 (1/4" collet)
Composite plastic housing



RG-382A-06 (6mm collet)
RG-382A-20 (1/4" collet)
Aluminium housing

■ Safety Lever Type



RG-38CX-06 (6mm collet)
RG-38CX-20 (1/4" collet)
Composite plastic housing



RG-383-06 (6mm collet)
RG-383-20 (1/4" collet)
Aluminium housing

*Back exhaust type is also available.
Model: RG-38BSLW

Safety Lever

- Slide up the stopper.
- Push down the lever.

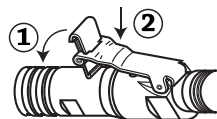

Option : 3 mm Collet Bushing

Code No.15000720



For changing 6 mm collet to 3 mm collet.
Just insert this bushing to 6 mm collet chuck.

Model	Code	Collet size mm/in	Capacity (Wheel size)		Max.free speed min ⁻¹	Overall length		Mass		Max. output		Air inlet thread Rc or NPT	Hose size		Average air consumption	
			mm	in		mm	in	kg	lb	kw	ps		mm	in	m ³ /min	ft ³ /min
RG-16AK-06	10725	6mm	φ16	5/8	35000	178	7	0.4	0.88	0.30	0.41	1/4	6.3	1/4	0.25	8.8
RG-16AKLW-06	10731	6mm	φ16	5/8	35000	178	6 ¹⁵ / ₁₆	0.4	0.88	0.30	0.41	1/4	6.3	1/4	0.25	8.8
RG-16AKLW-20	10806	1/4"														
RG-25-06	10140	6mm	φ20	13/16	30000	174	6 ⁷ / ₈	0.52	1.1	0.41	0.56	1/4	6.3	1/4	0.4	14.1
RG-25-20	10484	1/4"														
RG-25LW-06	10143	6mm	φ20	13/16	30000	176	6 ¹⁵ / ₁₆	1.1	2.4	0.41	0.56	1/4	6.3	1/4	0.4	14.1
RG-25LW-20	10486	1/4"														
RG-38CA-06	15303	6mm	φ25	1	22000	189	7 ⁷ / ₁₆	0.5	1.1	0.42	0.57	1/4	9.5	3/8	0.5	17.7
RG-38CA-20	15305	1/4"														
RG-382A-06	15304	6mm	φ25	1	22000	184	7 ¹ / ₄	0.5	1.1	0.42	0.57	1/4	9.5	3/8	0.5	17.7
RG-382A-20	15306	1/4"														
RG-38CX-06	15180	6mm	φ25	1	22000	183	7 ³ / ₁₆	0.6	1.3	0.42	0.57	1/4	9.5	3/8	0.5	17.7
RG-38CX-20	15302	1/4"														
RG-383-06	15179	6mm	φ25	1	22000	178	7	0.6	1.3	0.42	0.57	1/4	9.5	3/8	0.5	17.7
RG-383-20	15300	1/4"														

Vertical Grinders

- Outstanding grinding power provided by durable vertical motor.
- Ideal for grinding large areas.

■ Build-in Governor

■ Lever Type

● 180mm(7")



NVG-180SL

● 230mm(9")



NVG-230SL

■ Safety Lever Type

● 180mm(7")



NVG-180SLW

● 230mm(9")



NVG-230SLW

Wheel not included.

Model	Code	Capacity (Wheel size)		Spindle thread in	Max.free speed min ⁻¹	Overall length		Mass		Max. output		Air inlet thread Rc or NPT	Hose size		Average air consumption	
		mm	in			mm	in	kg	lb	kw	ps		mm	in	m ³ /min	ft ³ /min
NVG-180SL	10119	180x6x22	7x ¹ / ₄ x ⁷ / ₈	5/8"-11UNC	7100	187	7 ³ / ₈	3.8	8.4	1.87	2.54	3/8	12.7	1/2	1.1	38.8
NVG-180SLW	10120	180x6x22	7x ¹ / ₄ x ⁷ / ₈	5/8"-11UNC	7100	187	7 ³ / ₈	3.8	8.4	1.87	2.54	3/8	12.7	1/2	1.0	35.3
NVG-230SL	10122	230x6x22	9x ¹ / ₄ x ⁷ / ₈	5/8"-11UNC	5900	189	7 ⁷ / ₁₆	4.2	9.2	1.87	2.54	3/8	12.7	1/2	1.1	38.8
NVG-230SLW	10123	230x6x22	9x ¹ / ₄ x ⁷ / ₈	5/8"-11UNC	5900	189	7 ⁷ / ₁₆	4.2	9.2	1.87	2.54	3/8	12.7	1/2	1.1	38.8